

# INSTRUCTION MANUAL

BS07332105

## I. Installation Notice

1. Install water pipes in accordance with this manual.
2. Floor drain should be installed on the site.
3. All the components except mixer body should be installed only after the completion of house interior decoration in case paint or other chemicals erode the mixer surface.
4. Run water to clean pipes to get rid of mud, sand or other debris blocked in pipes before installation.
5. If the thread does not match well with the water pipe, please find out the reason first; otherwise a forced connection will damage the faucet.
6. After installation, check all the joints to ensure they are firmly connected. Turn on and off the water repeatedly to ensure there is no leakage around the joints. After that, the product is ready for normal use.
7. Keep the manual to users.

## II. Operation Notice

1. The product is used under water pressure 0.05~1.0 MPa, water temperature 4~90°C.
2. Do not hang heavy objects on the mixer.
3. Make sure the faucet is off when no water comes out of it, especially when nobody resides in or during the period of decoration or suspension of water.
4. Regularly clean the surface of faucet to keep it bright. Attention: Do not use inappropriate tools such as sharp brushes, rough sponges, scouring pads or corrosive detergent to clean the faucet. It is not recommended to use the detergent sold in the market, because its formula changes frequently. Please clean the faucet with wet cloth and soapy water after usage. Then rinse the soap off with clean water and dry with a soft cotton cloth.
5. Residues of shampoo, shower gel, hair dye, perfume, shaving water, nail polish, toothpaste and other substances may cause damage to the product. Please carefully rinse residues with clean water after use. Also, do not store detergents and chemicals under the product, such place as vanity cabinet of washbasin; otherwise volatile gases will damage the product.
6. When room temperature falls below 0°C, take necessary measures (keep the product warm, close windows) to prevent the product from frost cracking (especially when windows open for air ventilation while nobody in the house).
7. Turn on the cold water first, then hot water. Adjust the temperature before use to avoid scald.
8. Do not disassemble the product without help from the professionals.

## III. Installation Diagram

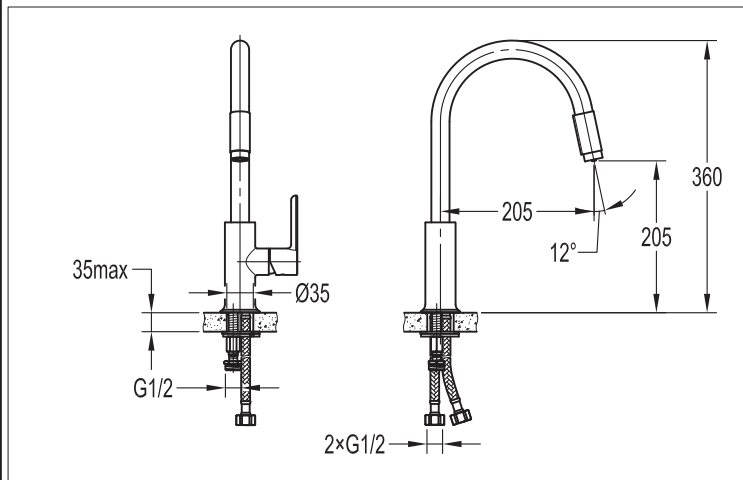

## IV. Installation Steps (Fig.1-6): \* The installation diagram is only for reference. The product is subject to the real object.

1

Prepare and check the following tools.

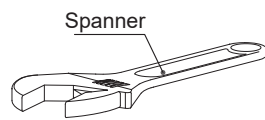

Spanner

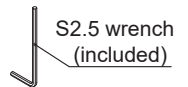

S2.5 wrench (included)

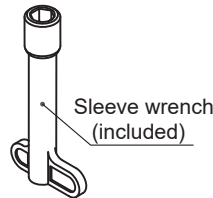

Sleeve wrench (included)

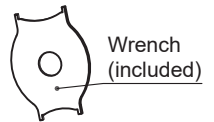

Wrench (included)

2

Remove G1/2 adapter, lock nut, lock washer and locating washer from mixer body one by one.

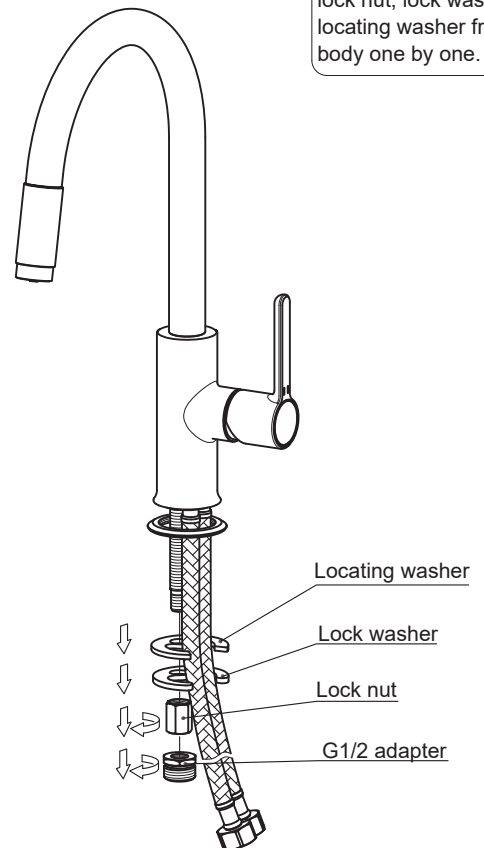

Locating washer

Lock washer

Lock nut

G1/2 adapter

3

Pass feeding hoses and connecting hose through hole of sink counter, then install mixer body and mounting piece onto the counter. Assemble back locating washer and lock nut back accordingly and tighten with the lock nut.

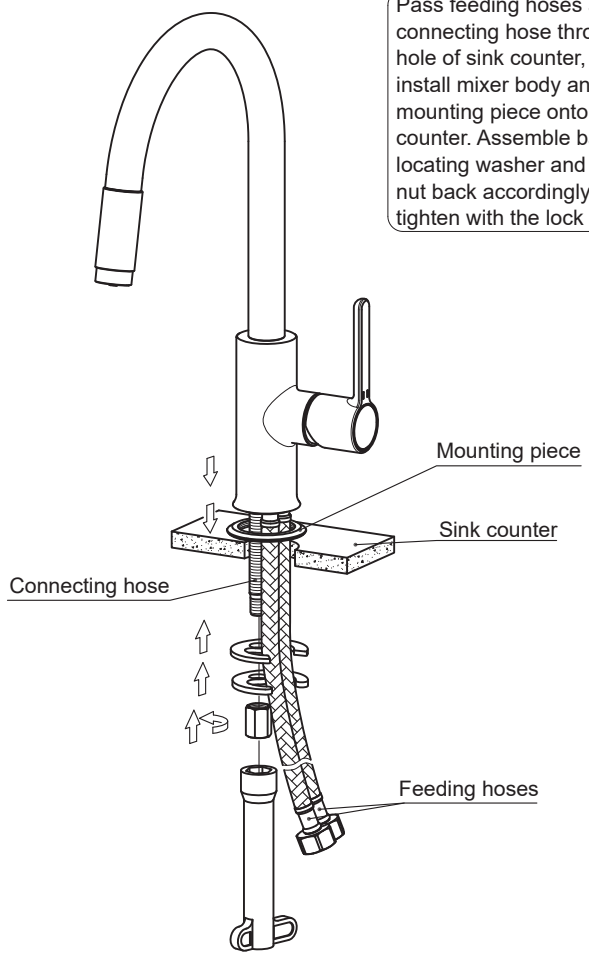

5

Turn on triangle valves and the handle. Tap water flows from the aerator.

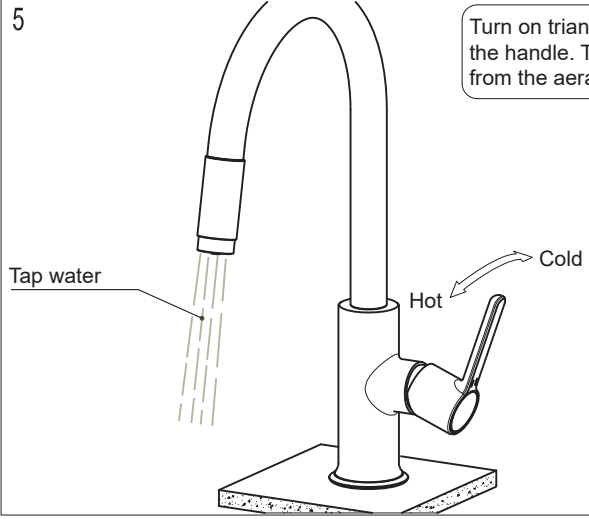

6

Turn off the handle, turn on the filtration and knob at the end of the spout. The filtered water flows from the small hole in the center of the aerator. The handle and knob work independently. Do not turn on both the handle and knob at the same time. Spout is 360° rotatable.

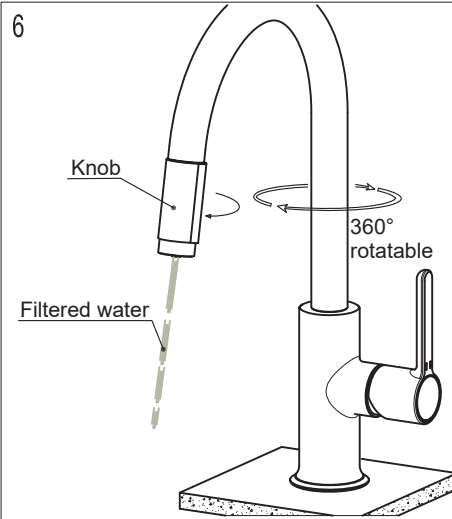

4

Connect feeding hoses to triangle valves. Please note that the valves must be connected for hot red and cold blue. Connect filtration tube to connecting hose. The mixer is equipped with G1/2, G1/4, and G3/8 adapters to match the specification of the actual filtration system.

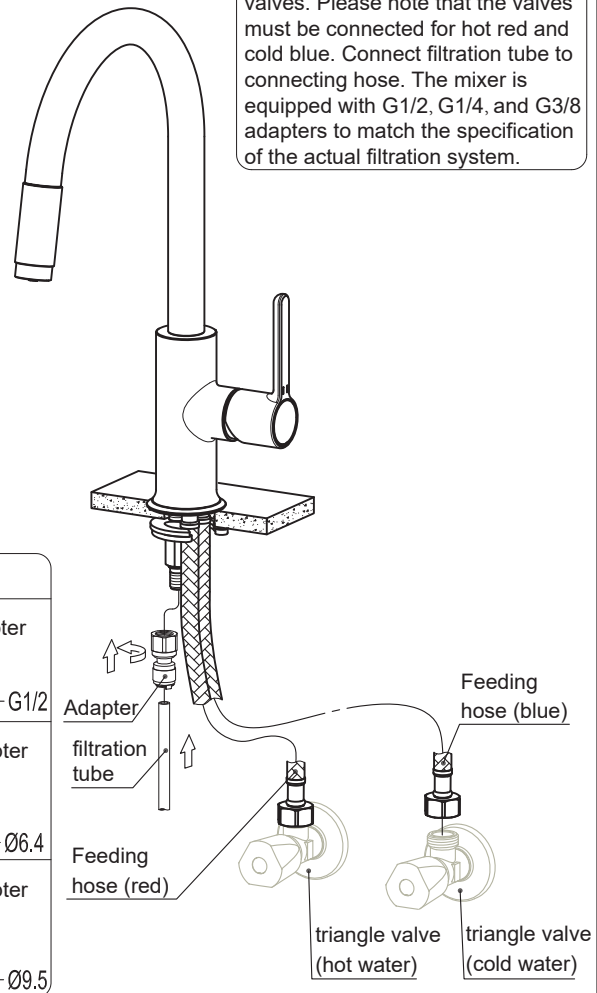

Adapter	
G1/2 adapter	G1/2
G1/4 adapter	Ø6.4
G3/8 adapter	Ø9.5

**V. Maintenance:**

If the the volume of tap water reduces after a period of usage, it is possibly because debris blocks the aerator. Cleaning method should be taken as shown in the following diagram: First turn off the handle, take off the aerator body with the provided wrench and remove the aerator and washer. Assemble them back after cleaning.

