

INSTRUCTION MANUAL

BS83161953

III. Operation Notice

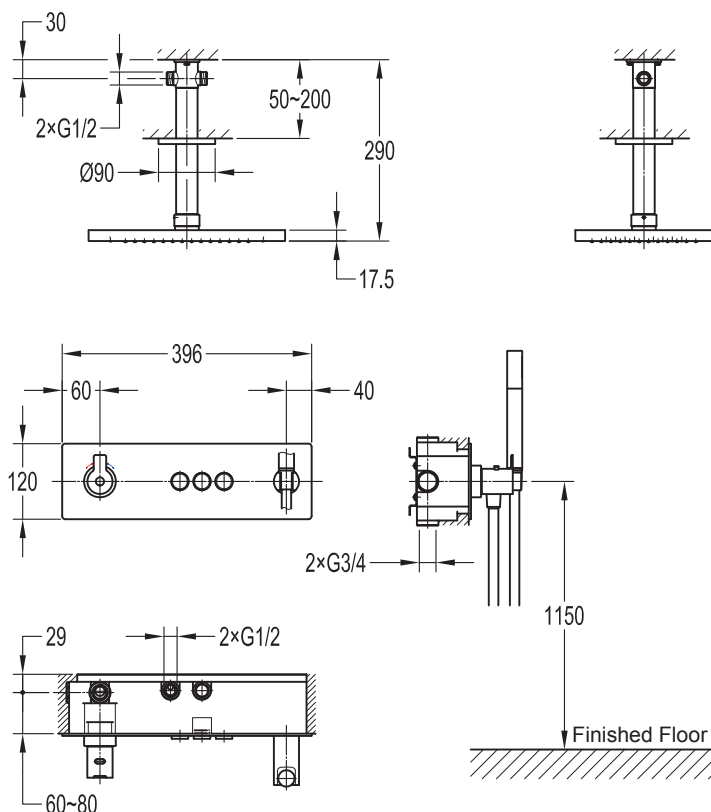

I. Installation Notice

1. Please lay water pipes in accordance with this manual. Floor drain should be installed on the site.
2. Mixers should be installed only after the completion of house interior decoration in case paint or other chemicals erode the mixer surface.
3. Clean pipes to get rid of mud, sand or other debris blocked in pipes before installation.
4. Check whether the threads can be matched. Otherwise, install forcefull will damage the components.
5. After installation, check all the joints to make sure they are firmly connected. Then keep water flow. Turn on and off repeatedly to ensure no leaking problem. After that, the product is ready for normal use. Then keep the manual to users.

II. Operation Notice

1. The product is used under cold water temperature 4~29°C, hot water temperature 55~85°C and water pressure 0.1~1.0 MPa. To avoid large pressure difference between hot and cold water, the thermostatic cartridge is preferably in use under the condition of water pressure 0.3 MPa, cold water 15°C, hot water 65°C. Main valve should be equipped with a filter.
2. Do not hang heavy things on the mixer. Do not use the mixer as handrail.
3. Remember to turn off the mixer when no water comes out of it (especially when nobody in the house or during the decoration period or power off).
4. Clean the surface of mixer regularly to keep it bright. Note: Please do not use inappropriate tools such as sharp brushes, rough sponges, scouring pads or corrosive detergent. And it is not recommended to use the detergent sold in the market, because its formula changes frequently. Please clean the mixer with wet cloth and soapy water after some time of usage. Then rinse the soap off with clean water and dry with a soft cotton cloth.
5. Residue left by shampoo, shower gel, hair dye, perfume, shaving water, nail polish, toothpaste could cause damage to the product. Clean it with water to wash off residue after using. Detergent and chemicals cannot be placed under the product as the volatile gas could damage the product.
6. When indoor temperature drops below 0°C, take necessary measures (keep mixer warm, close windows) to prevent the mixer from frost cracking (especially when windows are kept open for ventilation while nobody in the house).
7. Run cold water first and then run hot water, adjust the temperature before use. Do not touch the hot water area of the mixer to avoid injury.
8. Avoid sensitive part of human body (such as eyes) touching the water from the rain shower. Leave enough space form the rain shower to user's head.
9. Children and mentally disordered adults are not allowed to use the product without supervision. People affected by alcohol and drugs should also be forbidden from using.
Do not disassemble the product without help from the professionals.

IV. Installation Steps(Fig.1-33) : *

The installation diagram is only for reference. The product is subject to the real object.

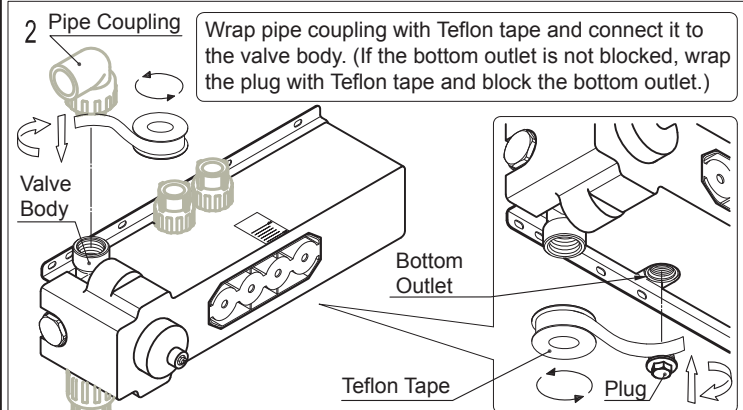
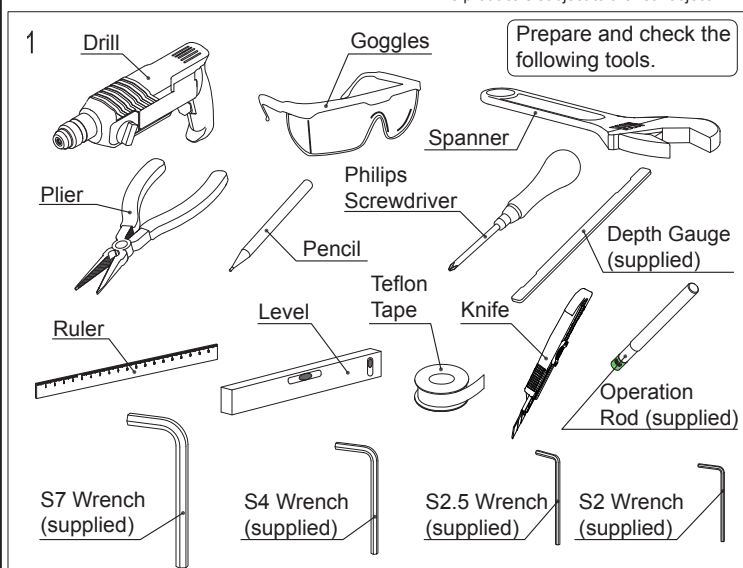

3

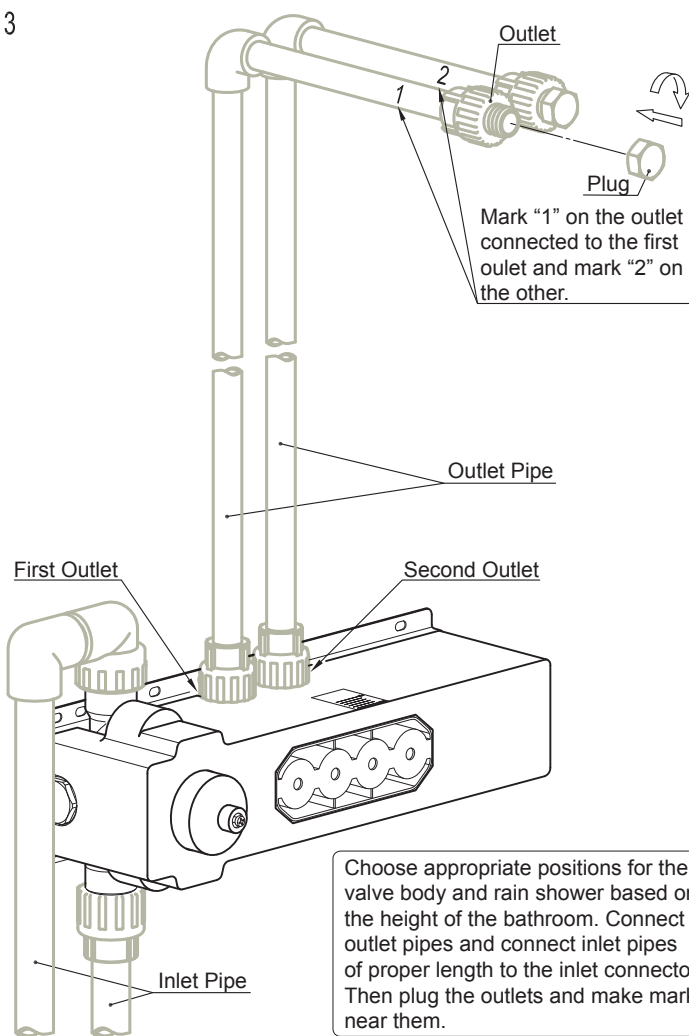

4

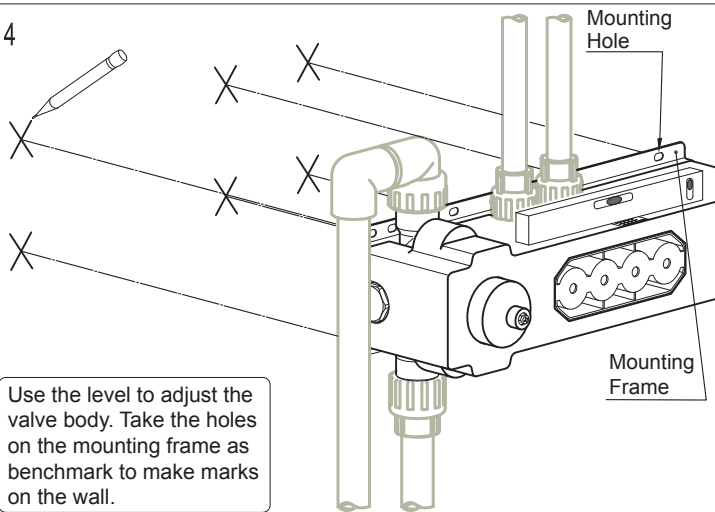

5

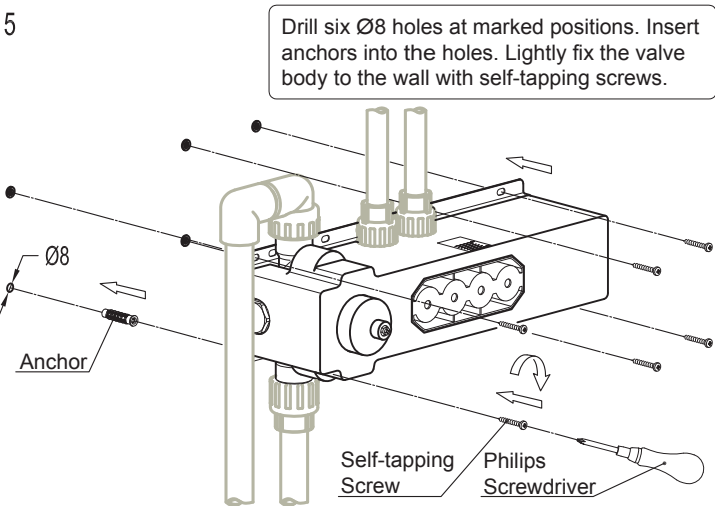

6

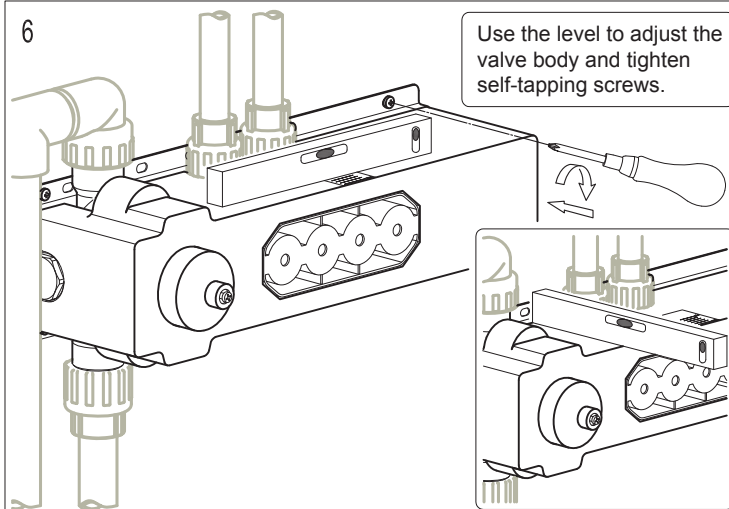

7

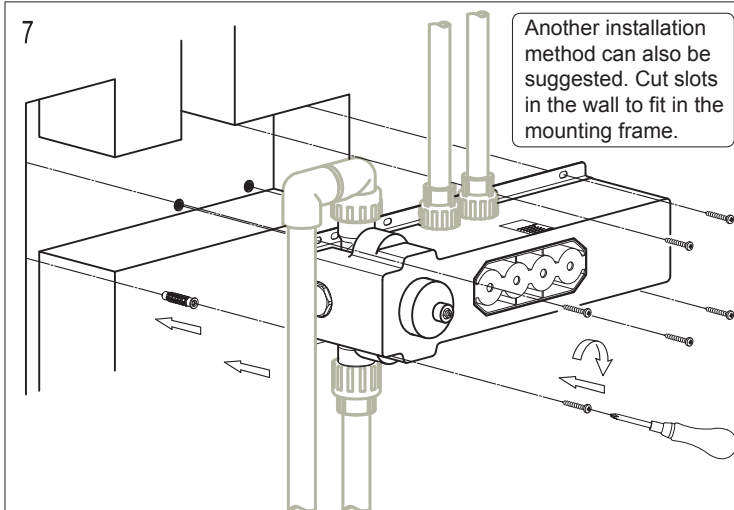

8

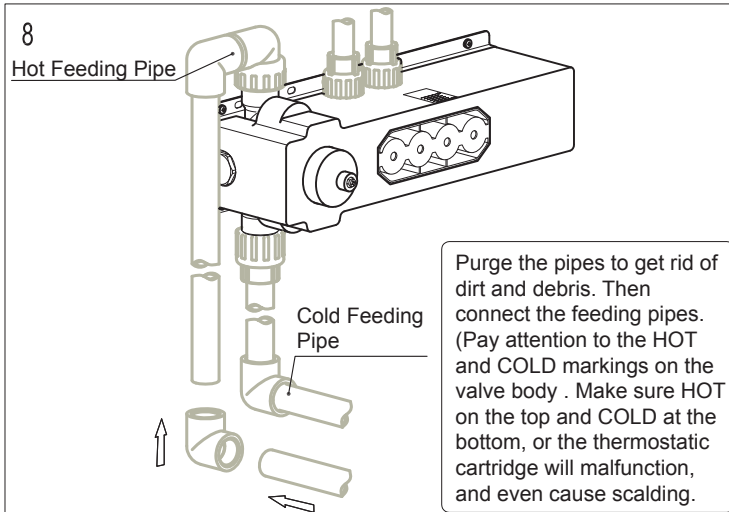

9

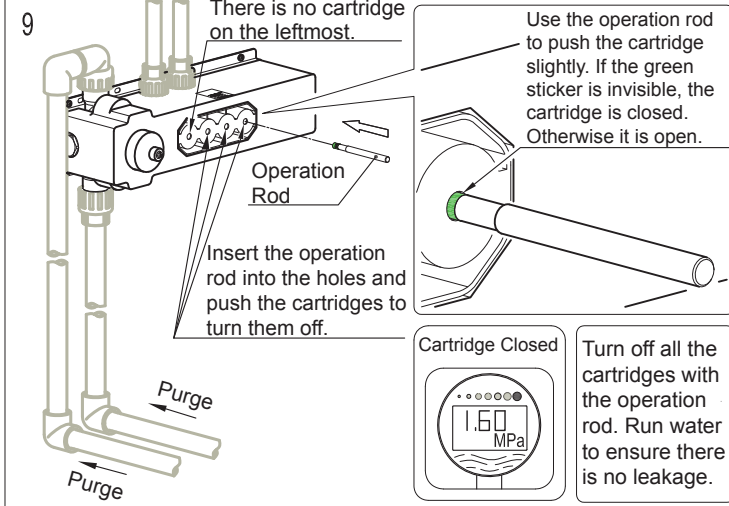

10

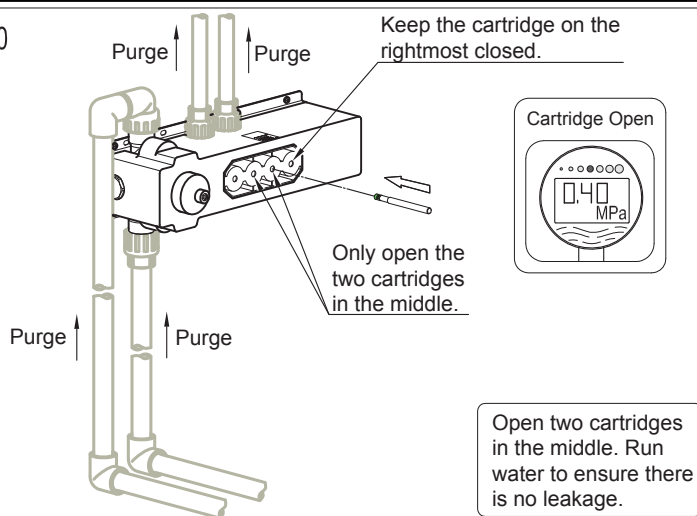

14

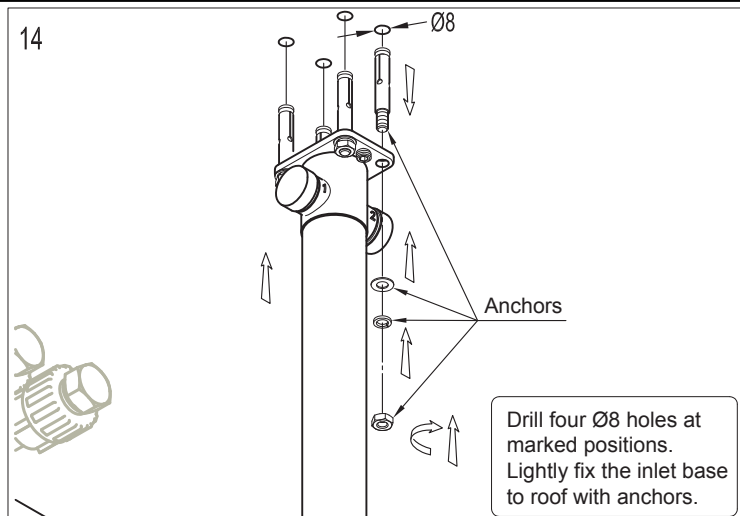

11

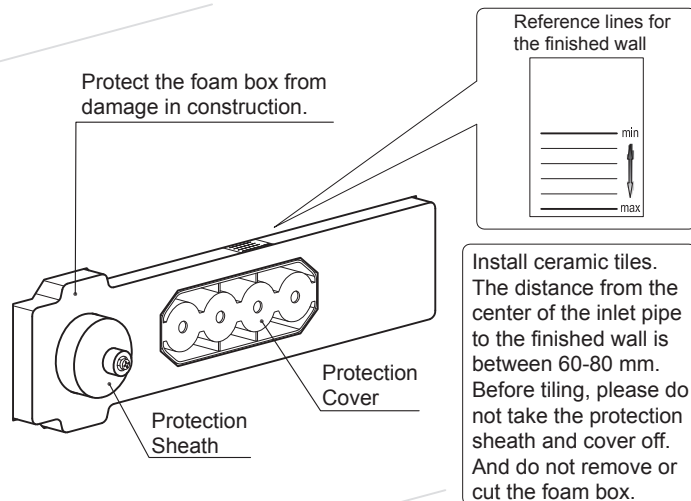

15

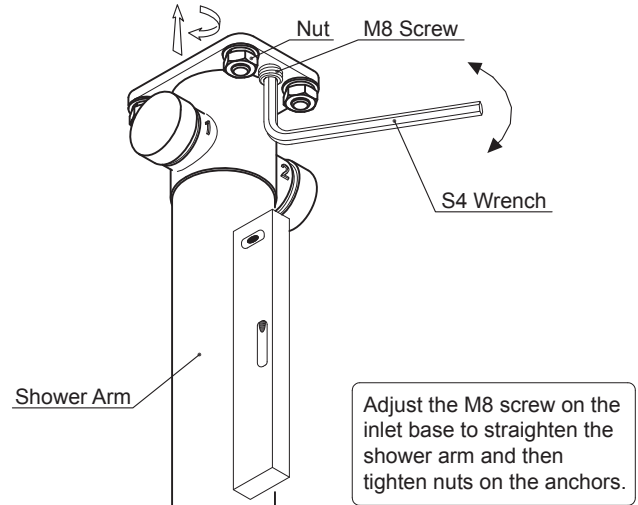

12

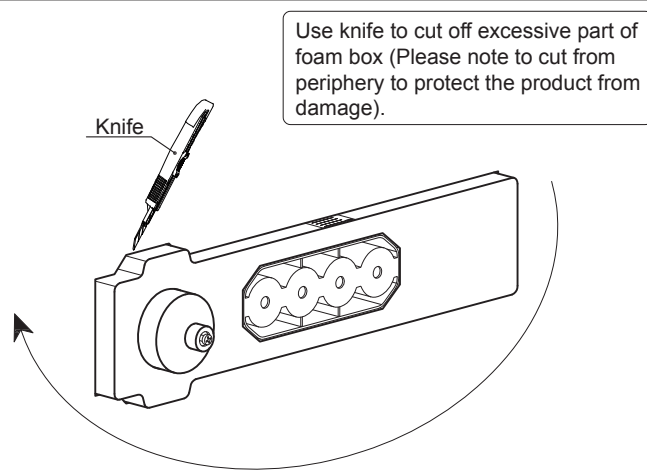

16

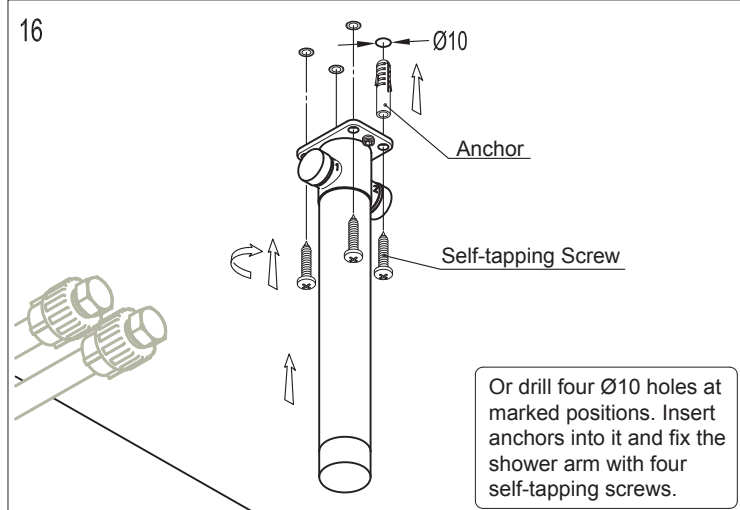

13

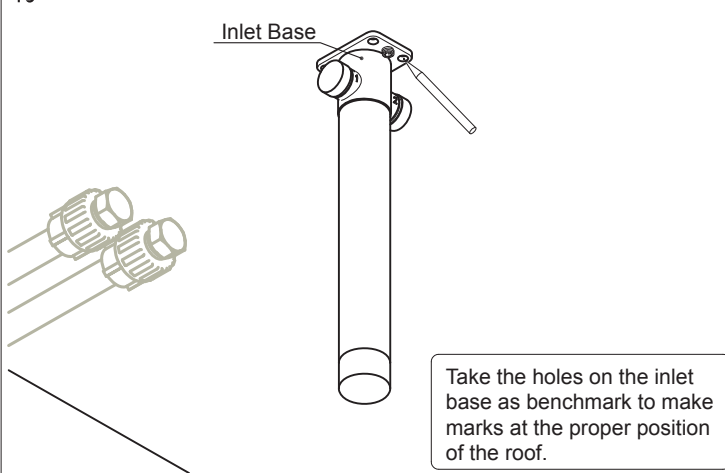

17

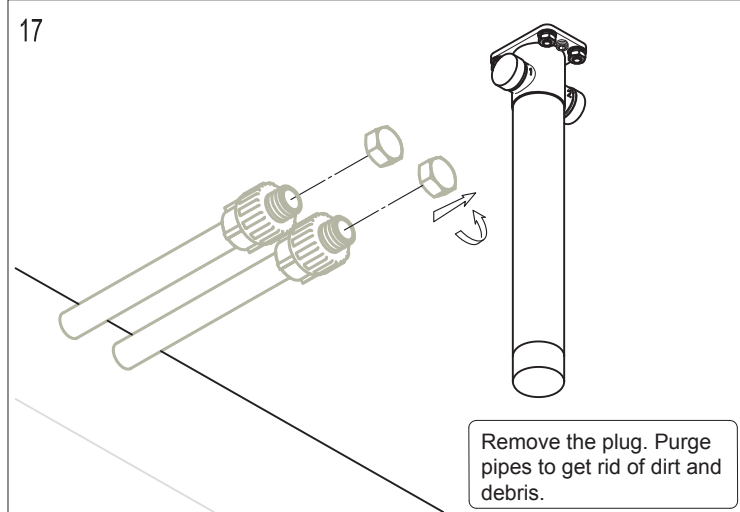

18

Remove the protection cap from the inlet base and connect to the outlets. Attention: The number on the inlet base should be matched with the number on outlets. ("1" is for the first outlet and "2" is for the second outlet.)

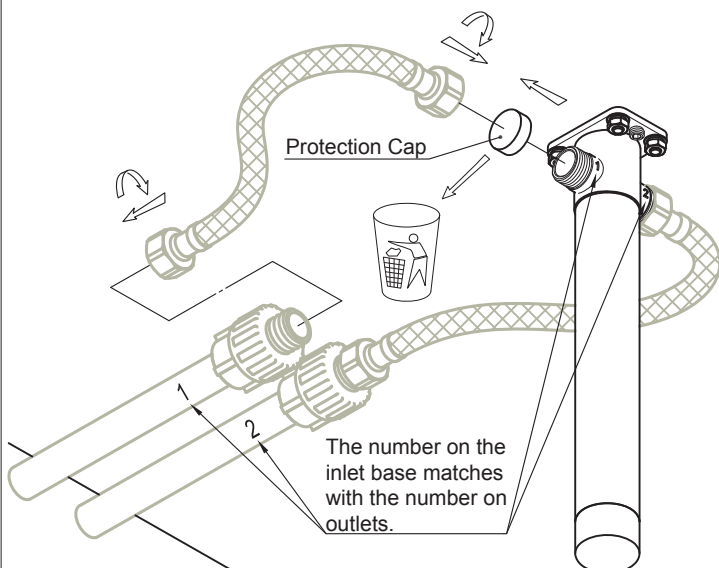

21

Take the protection cap from the shower head and screw it onto the shower arm. Note: Screw it to the end first, then screw it out for no more than half a turn. Keep the straight edge of the head shower parallel to the wall, and fasten it with the M4 screw.

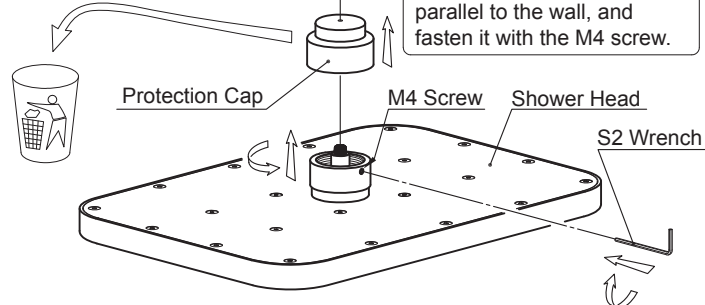

22

Take off protection sheath and cover.

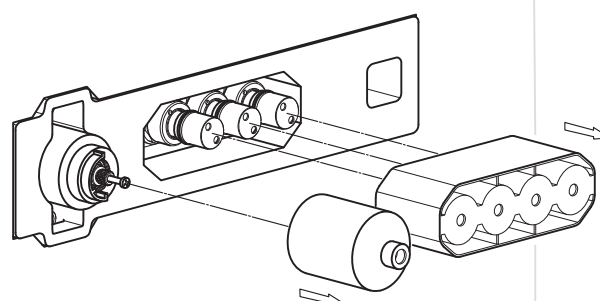

19

Ceiling-mounted Installation. Note: The height from the bottom of the inlet base to the drop ceiling is 50~200 mm.

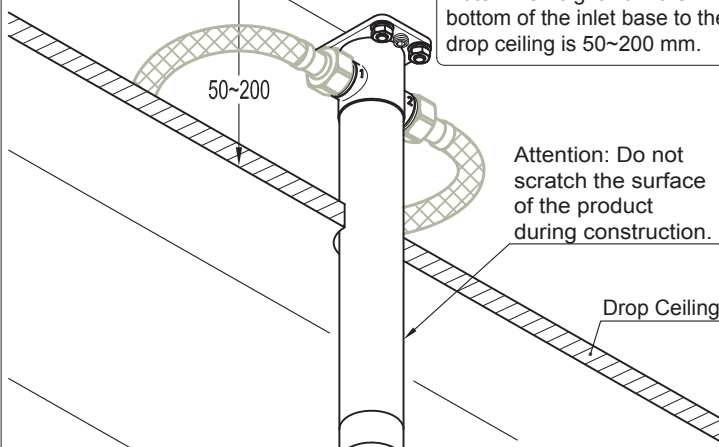

23. Make sure the cartridge is open. Place the depth gauge against the wall as shown in the diagram. If the upper surface of the cap is lower than or the same as the front side of the depth gauge, adjust the cap height to make them aligned with the front side of the depth gauge. Then do as shown in Diagram 26. If the upper surface of the cap is higher than the front side of the depth gauge, do as shown in Diagram 24.

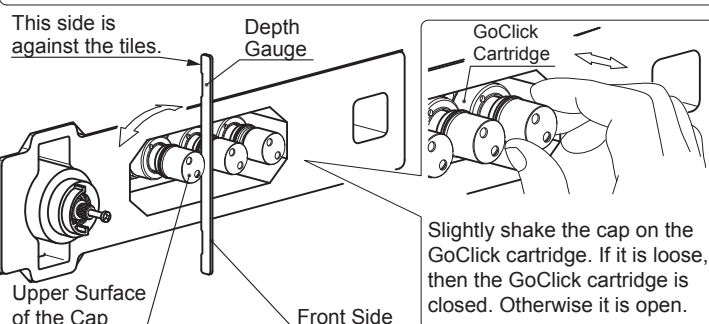

20

Remove the protection cap from the shower arm, then put on the escutcheon. Push the escutcheon until it is right against the drop ceiling.

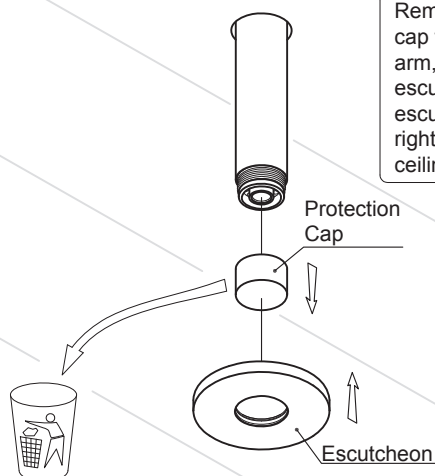

24

Replace with shorter adjustable threaded adapters and caps.

Replace all adjustable threaded adapters and caps.

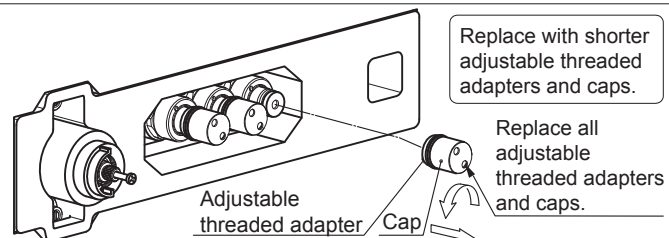

25

This side is against the tiles.

(Make sure GoClick cartridge is open.) Place the depth gauge against the wall as shown in the diagram. Based on the front side of depth gauge, adjust the cap height to make them aligned.

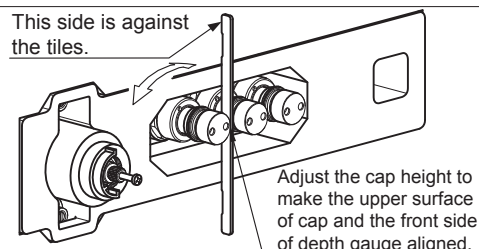

26

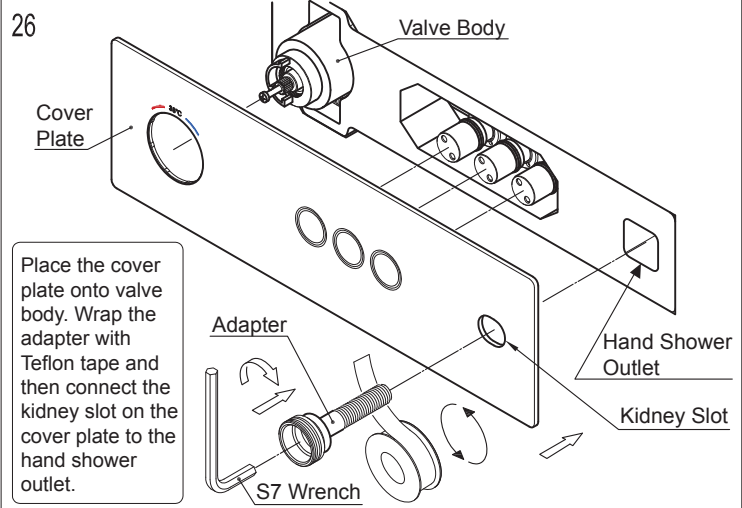

30

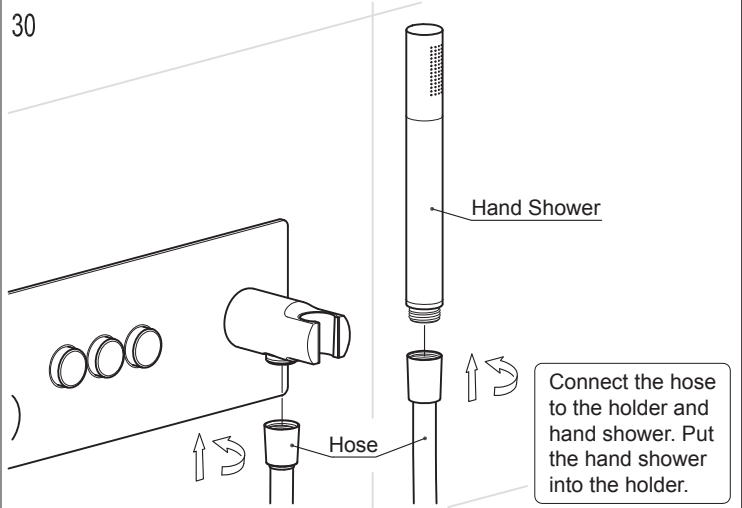

27

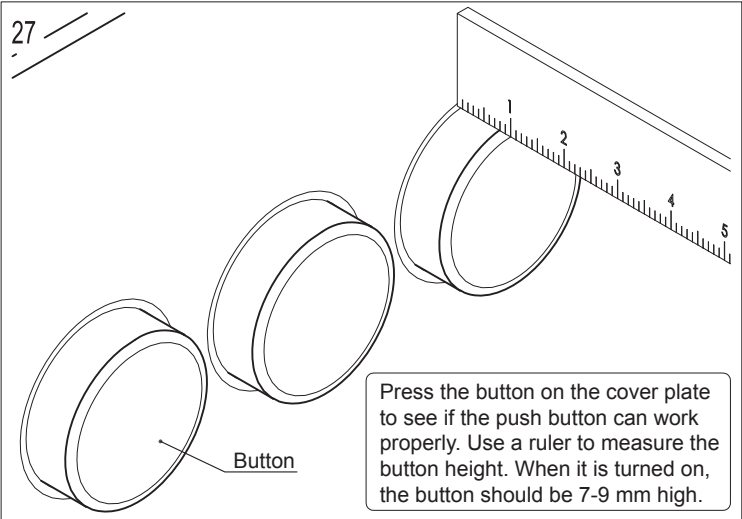

31

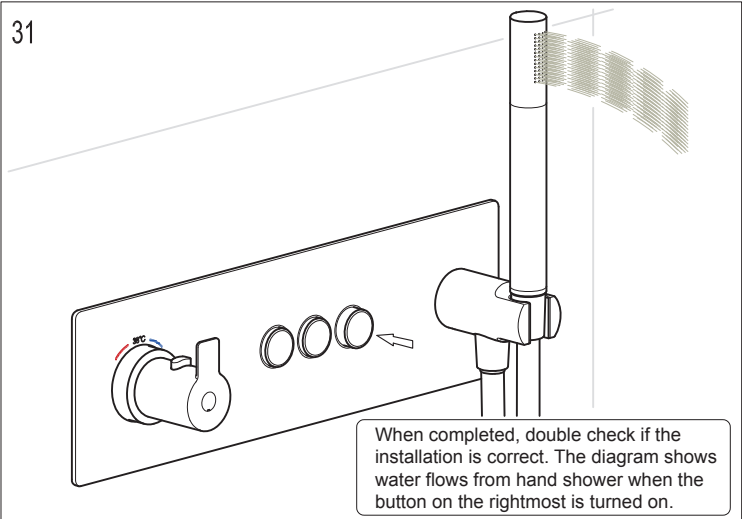

28

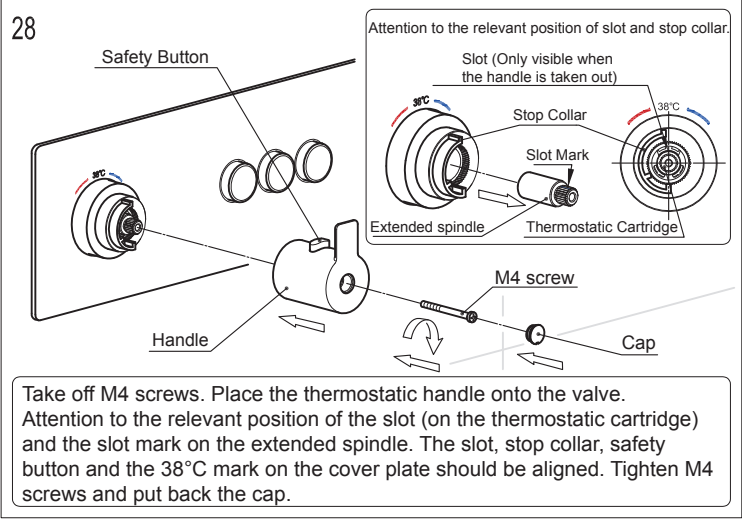

32

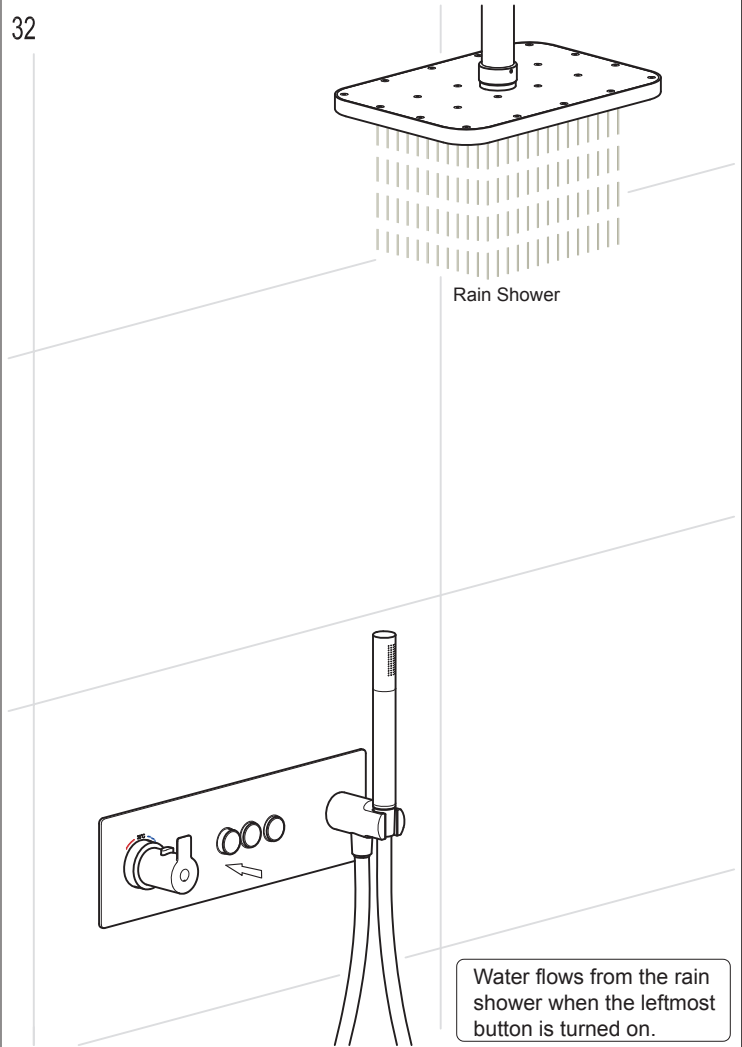

29

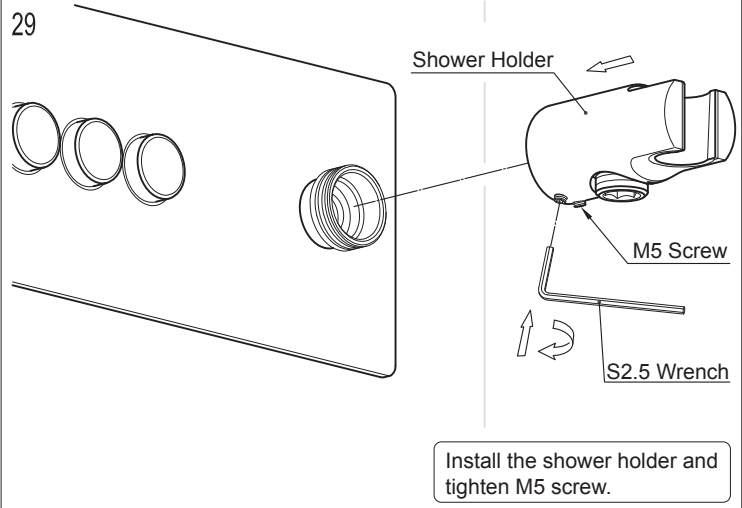

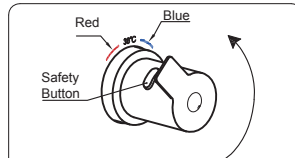
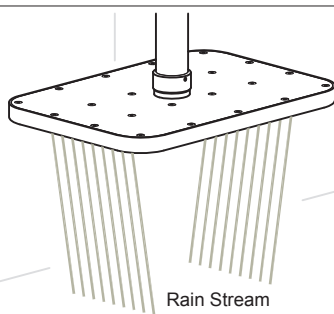

Water temperature rises when turn the thermostatic handle anticlockwise.

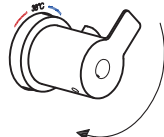

Water temperature lowers when turn the thermostatic handle clockwise.

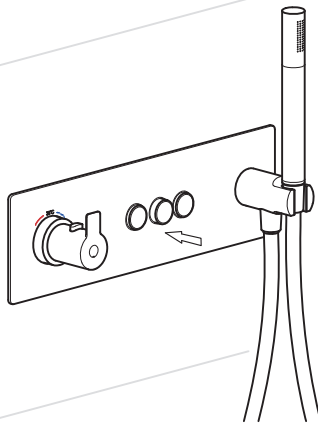

Water flows from rain stream when the middle button is turned on. Water temperature rises when turning the thermostatic handle anticlockwise. (If the temperature is desired above 38°C, the safety button should be pressed.) Water temperature lowers when turning the thermostatic handle clockwise.

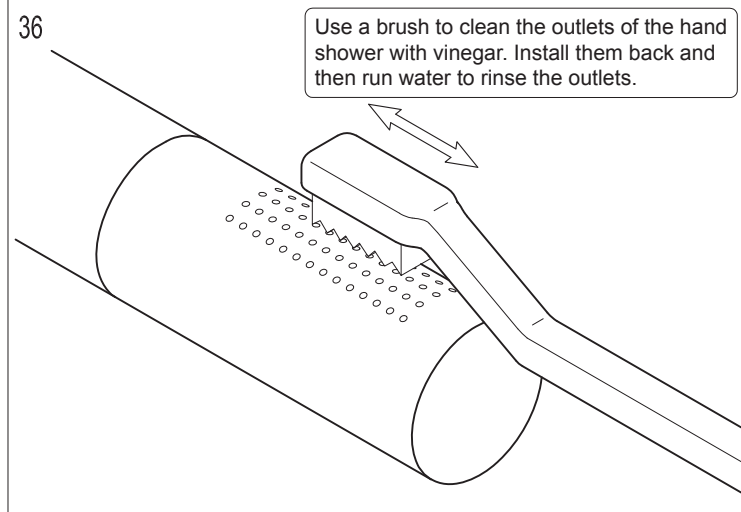
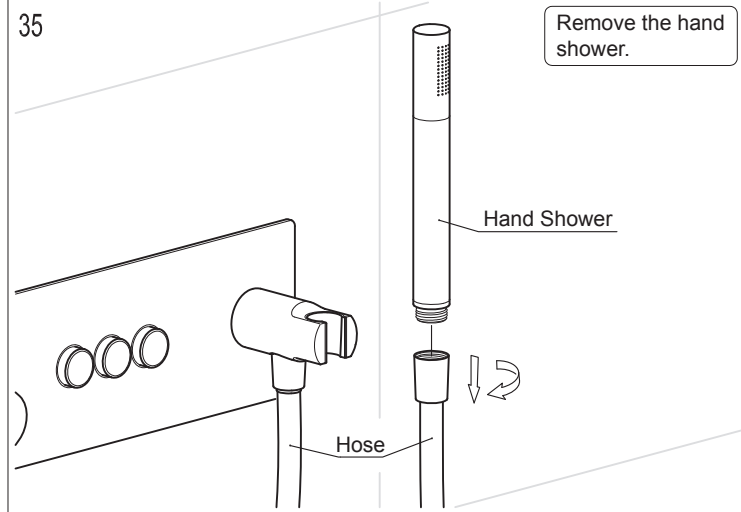

V. Maintenance

If water flow from the showers becomes lessened or does not spray evenly after a period of usage, it might be due to debris blocking the outlet. Please wash the rain shower or the hand shower as shown in Diagram 34-36.

If the flow rate is lessened or temperature control is imprecise, it is possibly due to water of poor quality blocking the small filters on both sides of the valve body or the filter on the thermostatic cartridge. Cleaning method should be taken as follows:

First, turn off the main valve. Take out the small filters as shown in Diagram 37 and 38. Then use a brush to clean the small filters with vinegar and clean water. Assemble them back after cleaning. Double check the flow volume and temperature control. If they still don't function properly, clean the filter of thermostatic cartridge as shown in the Diagram 39. Take out the thermostatic cartridge and clean the filter as before. Then assemble them back accordingly. If water flow from the hand shower is normal, but the water flow from rain shower or rain stream outlet is not, wash the filters and holes in the shower head as shown in Diagram 40-43. Then check the flow volume. If it still does not behave properly, take off the rain shower and shower arm as shown in Diagram 40 and 44. Clean the dirt on the filter of the shower arm. Finally install the shower arm and rain shower back as shown in Diagram 45 and 43.

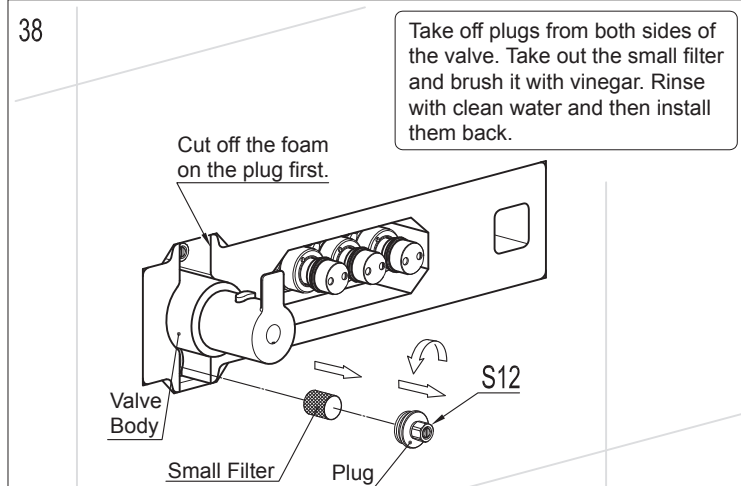
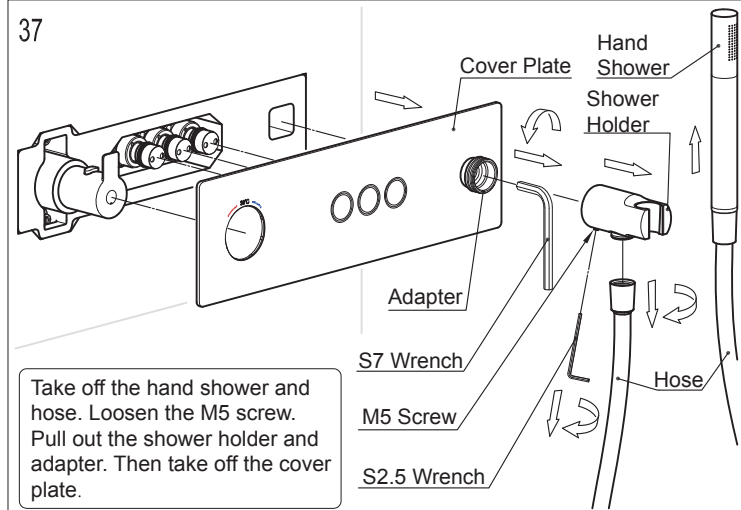
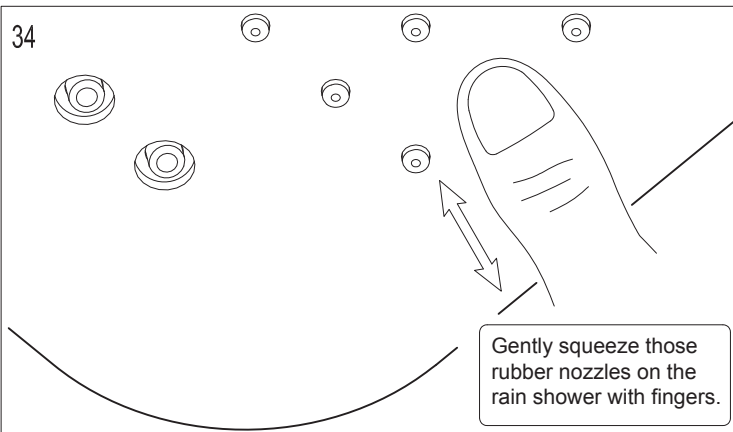

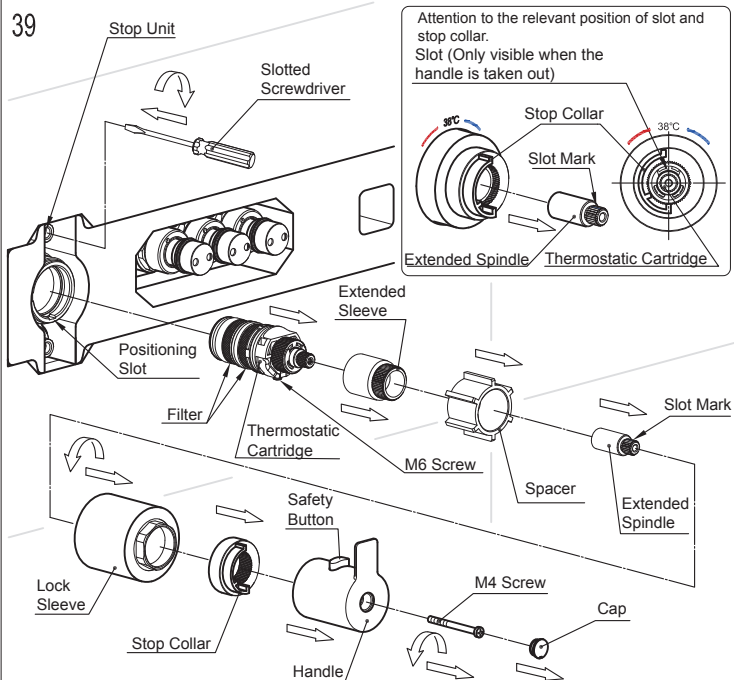

Tighten the stop units with Philips screwdriver to shut off hot and cold water. Pick out the cap with a sharp tool. Remove the followings in order: M4 screw, handle, stop collar, lock sleeve, extended spindle, spacer, extended sleeve. Finally take out the thermostatic cartridge and clean the filter. Then assemble thermostatic cartridge, extended spindle, extended sleeve, spacer and lock sleeve back accordingly. (Please note that the M6 screw on the thermostatic cartridge should be vertically downward and into the positioning slot of the thermostatic cartridge body.) Then switch the stopunit to initial position (to turn the cold and hot water on), assemble the plate cover, stop collar, thermostatic handle, M4 screw and cap back accordingly. (Please note to keep the four parts on one line: the slot on the thermostatic cartridge, stop collar, safety button and the 38°C mark on the cover plate.

